

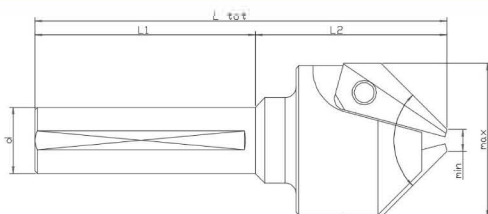

5500 Tomken Rd, Unit #2  
Mississauga, ON L4W 2Z4  
www.caliberindustrial.com  
sales@caliberindustrial.com

Mississauga: 905.624.5524  
Toronto: 416.626.7151  
Toll Free: 1.800.465.5743  
Fax: 905.602.8758



## Indexable countersink kits from **DIESSE TOOLING**

Countersinks with coated carbide inserts. Can be used  
countersinking, chamfering and peripheral milling.



## **CS DYNAMIC TOOLS**

### **COUNTERSINK TOOL KITS INCLUDING 3 INSERTS**

Includes Tool, 3 TiN coated inserts, 3 screws and 1 key.

EDP	Model	Range	Angle	Shank Size	Coolant Supply	Sale Price
341-DSUT.598.12.01	KCS12-2890	4-28mm	90°	12mm	External	\$255
341-DSTUT.598.12.01F	KCS12-2890-F	4-28mm	90°	12mm with Weldon flat	Internal	\$300
341-DSUT.598.16.02F	KCS16-2890-F	4-28mm	90°	16mm with Weldon flat	Internal	\$327
341-DSUT.598.16.01	KCS16-4090	16-40mm	90°	16mm	External	\$315
341-DSUT.598.12.03	KCS12-2860	11-28mm	60°	12mm	External	\$270



## **REPLACEMENT INSERT SETS AND SPARE PARTS**

Carbide blades, Coated and Un-Coated, with logarithmic  
cutting edge

Manufactured on 5 axis grinder

Each set consists of 3 Carbide Blades

Screws  
Key

DSUT.VRX.08  
DSUT.CRX.08

EDP	Model	Coating	Suggested Use	Sale Price
341-DSUT.519.2890	ST	Yes	Steel and Stainless	\$135.00
341-DSUT.519.2891	ALU	No	Aluminum and light alloys	\$132.00
341-DSUT.519.2892	GG	Yes	Grey Cast Iron	\$135.00

	P Steel	M Stainless	K Cast Iron	N Non Ferrous	S High Temp	H Hardened
Coated	260-490 sfm	130-260 sfm	325-650 sfm	-	65-148 sfm	33-112 sfm
Un-Coated	-	-	195-325 sfm	490-980 sfm	50-130 sfm	-

**Special Available Until Further Notice**

**DIESSE TOOLING**

**COUNTERSINKS WITH CARBIDE INSERTS**